

## PWF & PWFC

### Technical Data:

#### Aluminium

- Extrusion – PS uses multiple alloys & tempers which are established to be the most appropriate for the given use of individual parts are (6063-T5, T6, T52) as per ASTM B221.
- Profiles can be customised as per following alloys: (6061-T5, T6, T51) (6105-T5, T6) (6005-T5) (6005A-T5, T61), as per ASTM B221.
- Aluminium in contact with concrete/masonry will have a 2 mil heavy metal free high solids primer



#### Primary Seal

- Dual Durometer 65 Shore-A, 90 Shore-A, ASTM D2000
- Available in Standard Black colour.

MODEL	JOINT WIDTH	MINIMUM OPENING	MAXIMUM OPENING	EXPOSED SURFACE	BLOCKOUT WIDTH	BLOCKOUT HEIGHT
PWF-100	25mm	19mm	32mm	111mm	N/A	N/A
PWF-200	51mm	38mm	64mm	132mm	N/A	N/A
PWF-400	102mm	32mm	152mm	185mm	N/A	N/A
PWF-600	152mm	44mm	229mm	235mm	N/A	N/A
PWFC-100	25mm	19mm	32mm	68mm	N/A	N/A
PWFC-200	51mm	38mm	64mm	92mm	N/A	N/A
PWFC-400	102mm	32mm <td 152mm	143mm	N/A	N/A	
PWFC-600	152mm	44mm	229mm	194mm	N/A	N/A

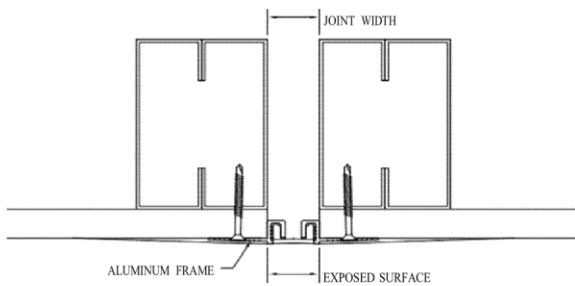

PWF-100

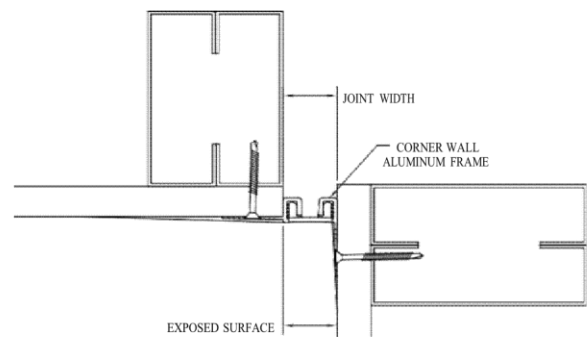

PWFC-100

