

Model PD 8500H

127 mm Storm Resistant Fixed Horizontal Louver

Material:

Material:	6063-T6 Alloy
Nominal Thickness	Heads: 1.52 mm Sills: 1.78 mm Jambs & Mullions: 1.60 mm
Nominal Blade Thickness:	1.52 mm
Furnished With:	Bird screen: 12.7mm intercrimp aluminum mesh, 1.6mm diameter wire removable aluminum bird screen in an aluminum frame
Additional Options (at additional cost):	Insect screen (in lieu of bird screen), Continuous clip angles for attachment Sheet blank off, Insulated blank off Sill pans, Flange frames Integrated glazing frames



Performance:

For a 4 Foot by 4 Foot Unit.

Tested with mill finish and no screen

- Free area = 7.32 ft² (0.681 m²)
- Percent free area = 45.8%
- Free area velocity at the point of beginning water penetration (@ 0.01oz. / ft² of free area based on a 15-minute interval test) = 1250 FPM (6.35 m/s)

Applications:

- Intake and exhaust applications requiring high free area
- Rain defense
- By protecting against wind, rain, and debris, storm-resistant louvers help preserve the integrity of buildings, equipment, and infrastructure. This can reduce the need for repairs or replacements, saving costs in the long run.
- In critical facilities like data centers, emergency shelters, and government buildings, storm-resistant louvers contribute to operational continuity during and after severe weather events.

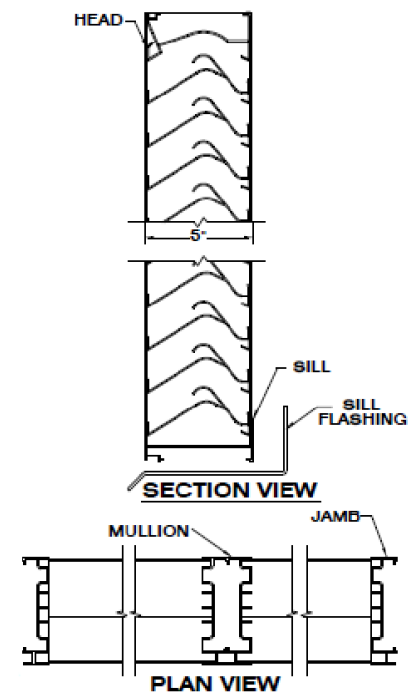

Finish Options



Kynar &
Powder
Coat



Pearlescent
& Metallic



Wood Grain
Patterns



Clear
Anodized



Custom
Color

Warranty

- One-Year Material Warranty
- 20-Year Finish Warranty