

EXPANSION JOINTS COVER SYSTEMS

PJP & PJPW

Technical Data:

Aluminum

- Extrusion – PS uses multiple alloys & tempers which are established to be the most appropriate for the given use of individual parts are (6063-T5, T6, T52) as per ASTM B221
- Profiles can be customised as per following alloys (6061-T5, T6, T51) (6105-T5, T6) (6005-T5) (6005A-T5, T61) as per ASTM B221
- Sheet – 6061-T6, 3003-H14, 5005-H34 as per ASTM B209

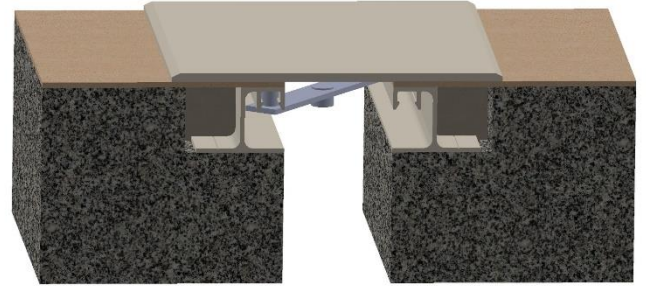

Stainless Steel

Type 304 as per ASTM A167

Turnbar

- Material – Stainless Steel Turnbar

Standard Loading
500 lbs.



Capable of Lateral Movement

PJP

MODEL	JOINT WIDTH	MINIMUM OPENING	MAXIMUM OPENING	EXPOSED SURFACE	BLOCKOUT WIDTH	BLOCKOUT HEIGHT
PJP-100	25mm	13mm	102mm	114mm	64mm	38mm
PJP-200	51mm	25mm	114mm	114mm	57mm	38mm
PJP-400	102mm	25mm	191mm	191mm	57mm	38mm
PJP-600	152mm	25mm	283mm	297mm	57mm	38mm
PJP-800	203mm	25mm	362mm	381mm	57mm	38mm
PJP-1000	254mm	25mm	425mm	457mm	57mm	38mm
PJP-1200	305mm	25mm	533mm	533mm	57mm	38mm
PJP-1400	356mm	25mm	603mm	610mm	57mm	38mm
PJP-1600	406mm	25mm	616mm	686mm	57mm	38mm

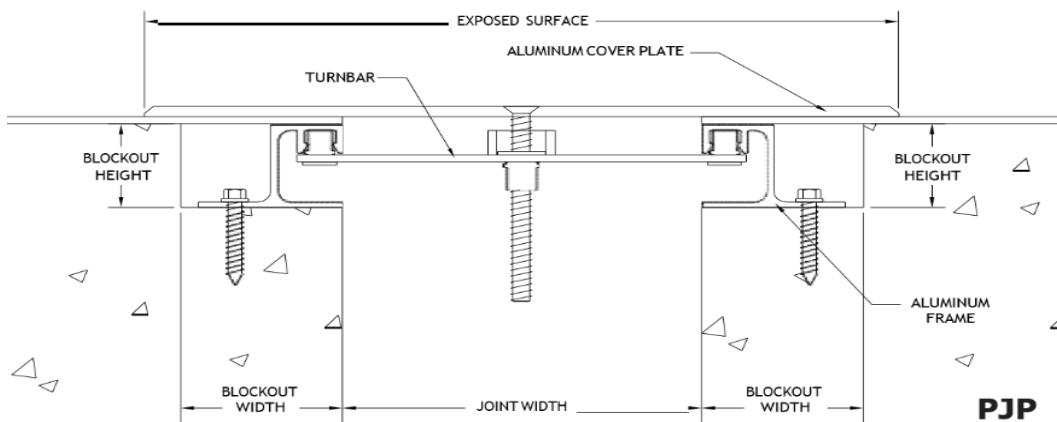

PJP

PJPW

MODEL	JOINT WIDTH	MINIMUM OPENING	MAXIMUM OPENING	EXPOSED SURFACE	BLOCKOUT WIDTH	BLOCKOUT HEIGHT
PJPW-100	25mm	0mm	64mm	83mm	64mm	38mm
PJPW-200	51mm	0mm	83mm	83mm	57mm	38mm
PJPW-400	102mm	0mm	146mm	146mm	57mm	38mm
PJPW-600	152mm	0mm	216mm	223mm	57mm	38mm
PJPW-800	203mm	114mm	254mm	292mm	57mm	38mm
PJPW-1000	254mm	140mm	338mm	356mm	57mm	38mm
PJPW-1200	305mm	165mm	419mm	419mm	57mm	38mm
PJPW-1400	356mm	191mm	476mm	483mm	57mm	38mm
PJPW-1600	406mm	216mm	508mm	546mm	57mm	38mm

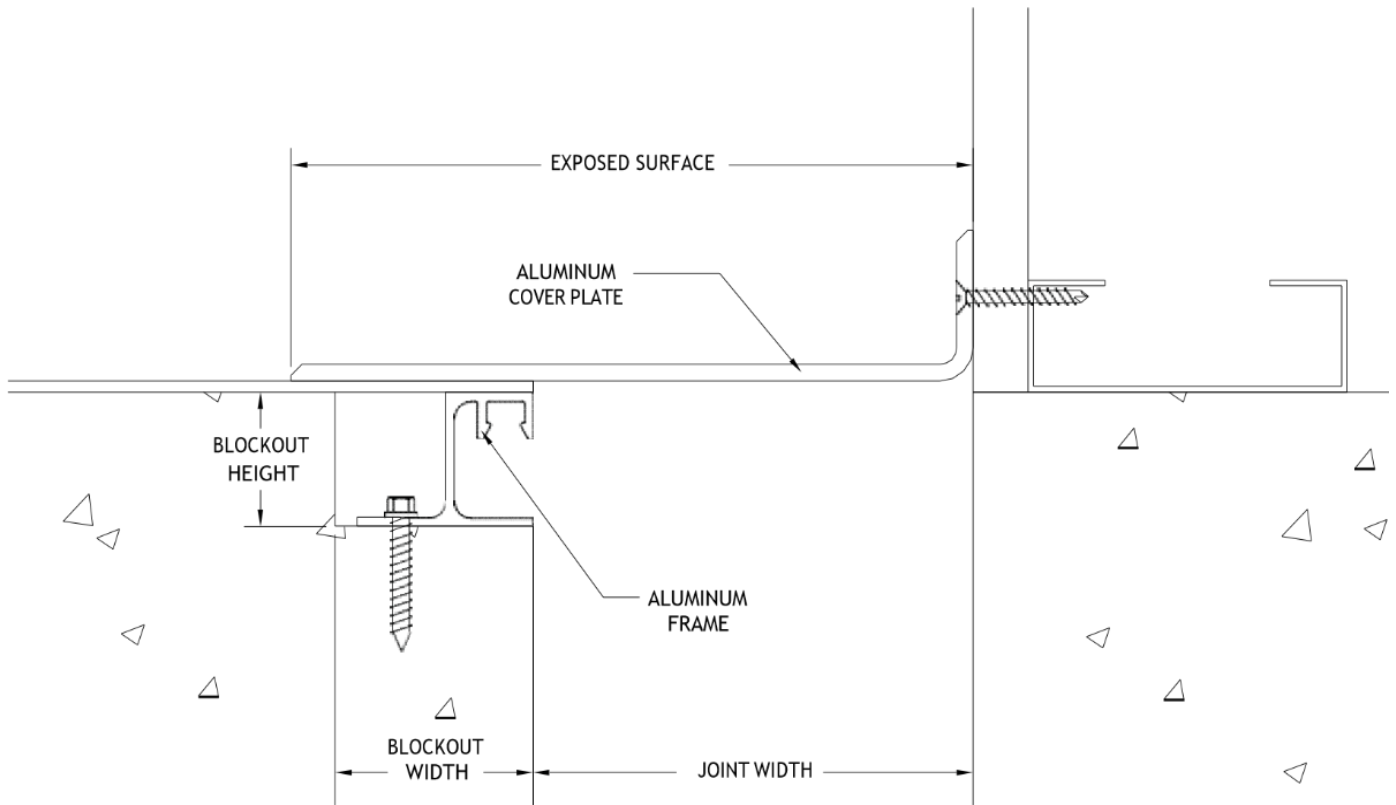

PJPW