

## Model PA 9080

### Acoustic Louver

#### General:

Furnish and install Pinnacle 8" (203 mm) Sound resistant fixed horizontal louver model PA 9080. They are designed to absorb sound and reduce noise transmission as manufactured by Pinnacle as per Complete details submitted in this TDS unless any specific changes to be done without hampering the desired performance.

#### Material :

Fixed blades and frame to be formed from 1100 series aluminum alloy. Jamb and slidable interlocking mullions to be structural members. Interior acoustical material to be fiberglass insulation protected by a woven fire retardant (self-extinguishing) 100% polyester sheeting. Material thickness shall be as follows: Heads, sills, jamb, mullion, and fixed blades to be: 0.081" (2 mm). All fasteners to be non-corrosive. (Optional: Accessories - All louvers to be furnished with 5/8" (15.87 mm) flattened expanded mesh, aluminum bird screen with a .055" (1.4 mm) thick extruded aluminum frame.) Screens and screen frames to be standard mill finish.

#### Structural Design:

Structural supports shall be designed and furnished by the louver manufacturer to carry a wind load.

#### Installation:

1. Examination: Examine openings to receive the work. Do not proceed until any unsatisfactory conditions have been corrected.
2. Installation
  - Comply with manufacturer's instructions and recommendations for installation of the work.
  - Verify dimensions of supporting structure at the site by accurate field measurements so that
  - the louver panels will be accurately designed, fabricated and fitted to the structure.
  - Anchor louvers to the building substructure as indicated on architectural drawings.
  - Correction: Do not cut or trim louver system on site.
  - Set units level, plumb and true to line, with uniform joints.

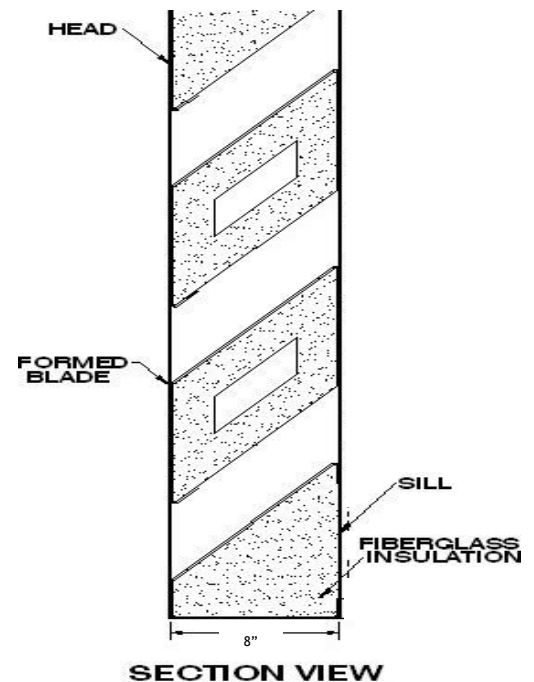
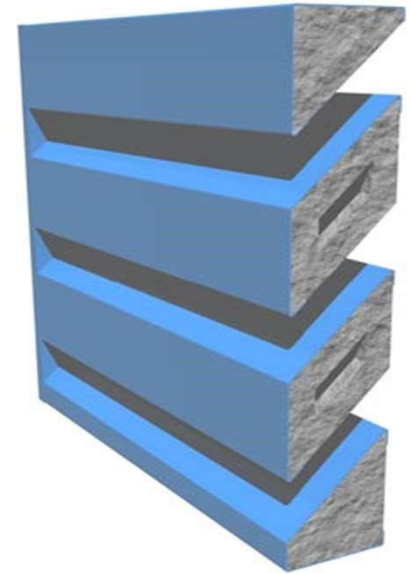

#### Finish Options



Kynar & Powder Coat



Pearlescent & Metallic



Wood Grain Patterns



Clear Anodized



Custom Color

#### Warranty

- Two-Year Material Warranty
- Finish Warranty as per Coating Selection



ARCHITECTURAL PRODUCT SOLUTIONS

---

PRODUCT DATA SHEET