

PLS & PLSW Series

Technical Data:

Aluminum

- Extrusion – PS uses multiple alloys & tempers which are established to be the most appropriate for the given use of individual parts are (6063-T5, T6, T52) (6061-T5, T6, T51) as per ASTM B221.
- Profiles can be customised as per following alloys (6105-T5, T6) (6005-T5) (6005A-T5, T61) as per ASTM B221.

Standard Loading

- 500 lbs.

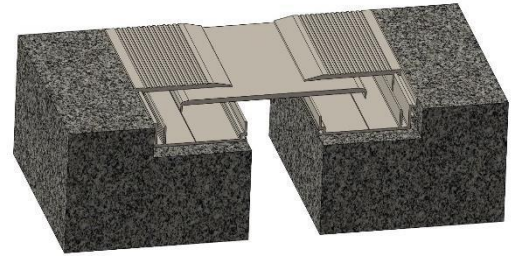

Capable of Lateral Movement

MODEL	JOINT WIDTH	MINIMUM OPENING	MAXIMUM OPENING	EXPOSED SURFACE	BLOCKOUT WIDTH	BLOCKOUT HEIGHT
PLS-200	51mm	10mm	102mm	197mm	73mm	25mm
PLS-400	102mm	22mm	176mm	298mm	99mm	25mm
PLSW-200	51mm	25mm	76mm	124mm	73mm	25mm
PLSW-400	102mm	62mm	140mm	200mm	99mm	25mm

