

Model PD 8550V
127 mm Storm Resistant Fixed Vertical Louver

Material:

Material:	6063-T6 Alloy
Nominal Thickness	Heads & Sills: 2.03mm Jamb & Mullions: 3.18 mm
Nominal Blade Thickness:	1.52 mm
Furnished With:	Bird screen: 12.7mm intercrimp aluminum mesh, 1.6mm diameter wire removable aluminum bird screen in an aluminum frame
Additional Options (at additional cost):	Insect screen (in lieu of bird screen), Continuous clip angles for attachment Sheet blank off, Insulated blank off Sill pans, Flange frames Integrated glazing frames

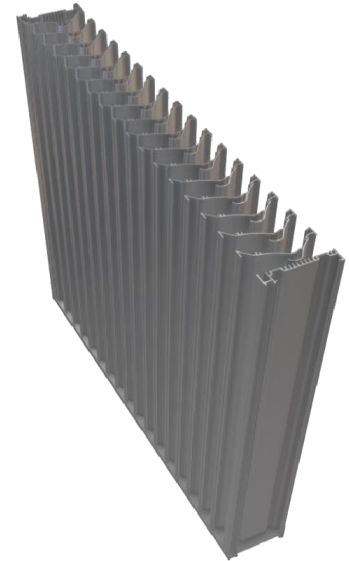

Performance:

For a 4 Foot by 4 Foot Unit.

Tested with mill finish and no screen

- Free area = 9.46 ft² (0.88 m²)
- Percent free area = 59.2%

Applications:

- Intake and exhaust applications requiring high free area
- Rain defense
- By protecting against wind, rain, and debris, storm-resistant louvers help preserve the integrity of buildings, equipment, and infrastructure. This can reduce the need for repairs or replacements, saving costs in the long run.
- In critical facilities like data centers, emergency shelters, and government buildings, storm-resistant louvers contribute to operational continuity during and after severe weather events.

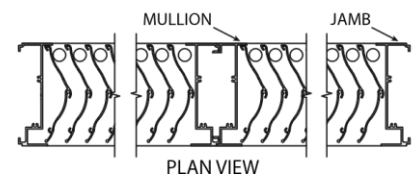
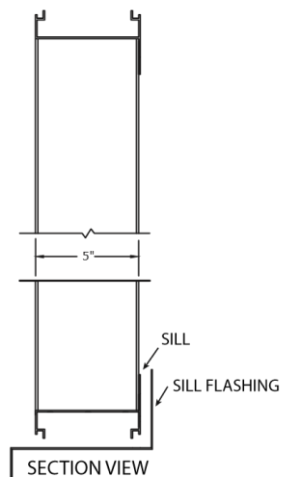

Finish Options



Kynar & Powder Coat



Pearlescent & Metallic



Wood Grain Patterns



Clear Anodized



Custom Color

Warranty

- One-Year Material Warranty
- Finish Warranty as per Coating Selection