

PSFW & PSCW MOD

Technical Data:

Aluminum

- Extrusion – PS uses multiple alloys & tempers which are established to be the most appropriate for the given use of individual parts are (6063-T5, T6, T52) as per ASTM B221 Profiles can be customised as per following alloys (6061-T5, T6, T51), (6105-T5, T6), (6005-T5), (6005A-T5, T6) as per ASTM B221

Sheet – 19000 M, 19000 H2, 31000 H2, 31000 H3, 1100/1200

Stainless Steel formed center plate

- Type 304 as per ASTM A167, A240A, A240M

Duroflex Gasket

- Single Durometer – 80 Shore A, as per ASTM D200
- Color – Black

Turnbar :

- Material – Stainless Steel Turnbar



MODEL	JOINT WIDTH	MINIMUM OPENING	MAXIMUM OPENING	EXPOSED SURFACE	BLOCKOUT WIDTH	BLOCKOUT HEIGHT
PSFW-400	102mm	73mm	184mm	191mm	N/A	N/A
PSFW-600	152mm	73mm	235mm	303mm	N/A	N/A
PSFW-800	203mm	73mm	359mm	381mm	N/A	N/A
PSFW-1000	254mm	73mm	448mm	456mm	N/A	N/A
PSFW-1200	305mm	73mm	470mm	533mm	N/A	N/A
PSFW-1400	356mm	73mm	578mm	608mm	N/A	N/A
PSFW-1600	406mm	73mm	657mm	686mm	N/A	N/A

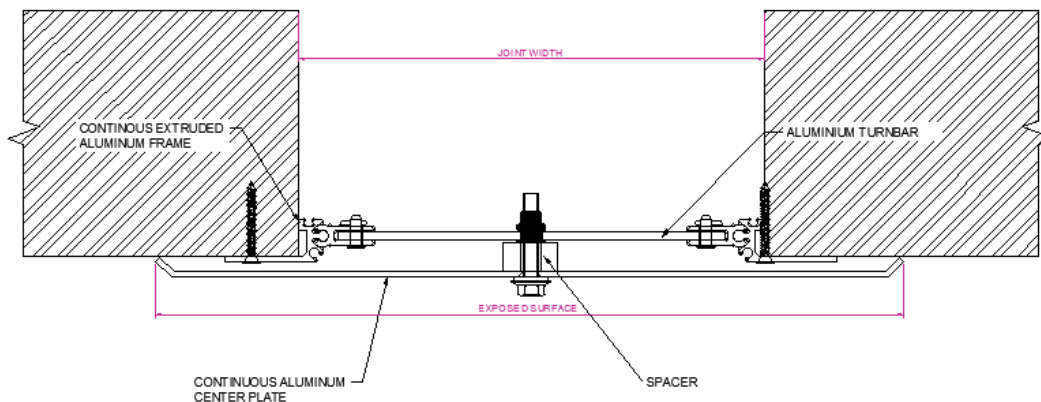

PSFW

EXPANSION JOINTS COVER SYSTEMS

MODEL	JOINT WIDTH	MINIMUM OPENING	MAXIMUM OPENING	EXPOSED SURFACE	BLOCKOUT WIDTH	BLOCKOUT HEIGHT
PSCW-400	102mm	10mm	141mm	146mm	N/A	N/A
PSCW-600	152mm	10mm	224mm	229mm	N/A	N/A
PSCW-800	203mm	138mm	281mm	292mm	N/A	N/A
PSCW-1000	254mm	164mm	353mm	356mm	N/A	N/A
PSCW-1200	305mm	189mm	389mm	419mm	N/A	N/A
PSCW-1400	356mm	214mm	467mm	483mm	N/A	N/A
PSCW-1600	406mm	240mm	492mm	546mm	N/A	N/A

NOTE: No turnbar required for PSCW 4"-6" Use chart above for stainless models Call factory for joints larger than 16" steel and bronze options.

