

**Model PD 8440V**  
**101.6 mm Storm Resistant Fixed Vertical Louver**

**Material:**

<b>Material:</b>	6063-T6 Alloy
<b>Nominal Thickness</b>	Heads & Sills: 2.03mm Jambs & Mullions: 3.18 mm
<b>Nominal Blade Thickness:</b>	1.52 mm
<b>Furnished With:</b>	Bird screen: 12.7mm intercrimp aluminum mesh, 1.6mm diameter wire removable aluminum bird screen in an aluminum frame
<b>Additional Options (at additional cost):</b>	Insect screen (in lieu of bird screen), Continuous clip angles for attachment Sheet blank off, Insulated blank off Sill pans, Flange frames Integrated glazing frames

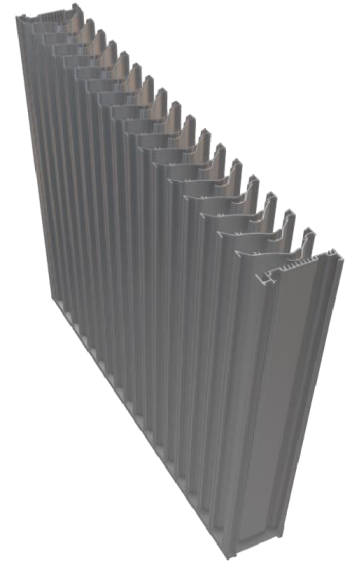

**Performance:**

**For a 4 Foot by 4 Foot Unit.**

Tested with mill finish and no screen

- Free area = 9.46 ft<sup>2</sup> (0.88 m<sup>2</sup>)
- Percent free area = 59.2%

**Applications:**

- Intake and exhaust applications requiring high free area
- Rain defense
- By protecting against wind, rain, and debris, storm-resistant louvers help preserve the integrity of buildings, equipment, and infrastructure. This can reduce the need for repairs or replacements, saving costs in the long run.
- In critical facilities like data centers, emergency shelters, and government buildings, storm-resistant louvers contribute to operational continuity during and after severe weather events.

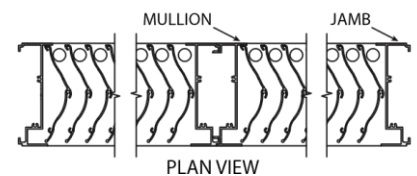
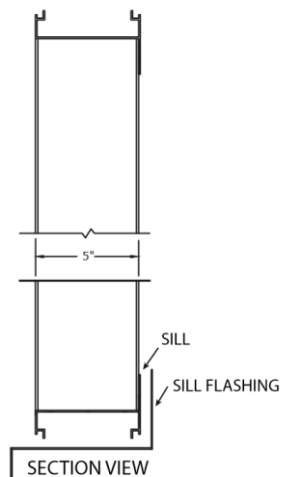

**Finish Options**



Kynar & Powder Coat



Pearlescent & Metallic



Wood Grain Patterns



Clear Anodized



Custom Color

**Warranty**

- One-Year Material Warranty
- Finish Warranty as per Coating Selection