

## PSM-X & PSMC-X Series

### TECHNICAL DATA:

Aluminum

- Extrusion – PS uses multiple alloys & tempers which are established to be the most appropriate for the given use of individual parts are (6063-T5, T6, T52).

Profiles can be customised as per following alloys: (6061-T5, T6, T51)  
(6105-T5, T6) (6005-T5) (6005A-T5, T6), as per ASTM B221

Duroflex Gasket

- Single Durometer – 80 Shore A, ASTM D2000
- Color – Black

Vapor Barrier

- Material – 1/1.2mm Thick EPDM

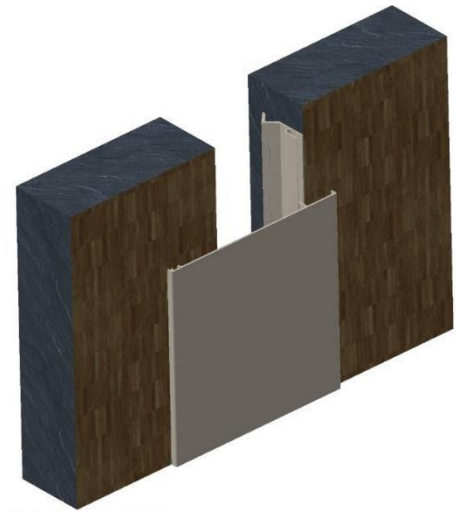

MODEL	JOINT WIDTH	MINIMUM OPENING	MAXIMUM OPENING	SURFACE EXPOSED	BLOCKOUT WIDTH	BLOCKOUT HEIGHT
PSM-200X	50mm	10mm	76mm	118mm	N/A	N/A
PSM-400X	100mm	10mm	152mm	194mm	N/A	N/A
PSM-600M X	150mm	10mm	235mm	260mm	N/A	N/A
PSM-800M X	200mm	10mm	285mm	340mm	N/A	N/A
PSMC-200X	50mm	13mm	76mm	86mm	N/A	N/A
PSMC-400X	100mm	13mm	152mm	162mm	N/A	N/A
PSMC-600M X	150mm	30mm	235mm	230mm	N/A	N/A
PSMC-800M X	200mm	30mm	285mm	310mm	N/A	N/A

