

Model PD 7200

50.8 mm High-Performance Drainable Fixed Mullion Louver

Material:

Material:	6063-T6 Alloy
Nominal Thickness (heads, sills, jambs, & mullions):	1.60 mm
Nominal Blade Thickness:	1.60 mm
Furnished With:	Bird screen: 12.7mm intercrimp aluminum mesh, 1.6mm diameter wire removable aluminum bird screen in an aluminum frame
Additional Options (at additional cost):	Insect screen (in lieu of bird screen), Continuous clip angles for attachment Sheet blank off, Insulated blank off Sill pans, Flange frames Integrated glazing frames



Performance:

For a 4 Foot by 4 Foot Unit.

Tested with mill finish and no screen

- Free area = 8.84 ft² (0.821 m²)
- Percent free area = 55.3%

Applications:

- Intake and exhaust applications requiring high free area
- Rain defense
- Building envelope customization with non-functioning louvers

Finish Options



Kynar &
Powder
Coat



Pearlescent
& Metallic



Wood Grain
Patterns



Clear
Anodized



Custom
Color

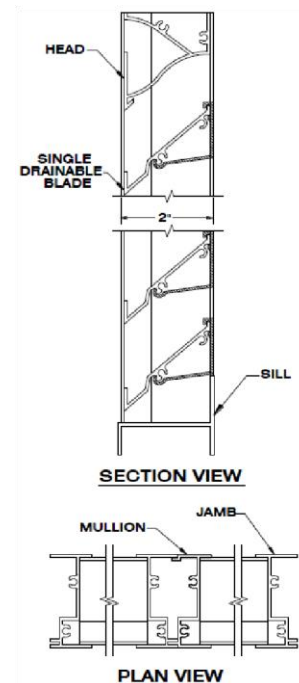

Warranty

- One-Year Material Warranty
- Finish Warranty as per Coating Selection